

Flanges and Axis Extension

Data-Sheet

The INTRA Base-Unit has one flange on each axis. The other end of the tubular axis ends inside the case allowing an easy (case-internal) feed-through of the cables of the instruments installed on the secondary axis. But if one flange does not provide enough space to accommodate all of your instruments, you may add a second flange using the axis extension on the secondary axis. This second flange is capable of carrying the same load as the flange type 2 (with sun-monitor) which is already attached to the secondary axis.

The axis extension

- has slits for the feed through of cables from one axis to the other (or to the controller as used e. g. for the cable of the sun-monitor).
- is designed for easy installation by the user.

You will also need the axis extension and the flange type 1 if you add a shading disk mechanism -single or double type - to INTRA. Please refer to the corresponding data sheets of the Shading Disk Kit or the Dual Shading Disk Kit. These Kits include all necessary parts – including the axis extension kit.

Technical Information

material: aluminium
surface finish: anodized (metallic)

Ordering Information

flange type 1 parts number: TP01-1
axis extension parts number: TP02

Note:

flange type 2 has the same dimensions and provides an opening to accept the sun monitor.

Parts include screws (allen-type, stainless steel) needed for installation. No special tools are required for the installation.

Fig. 1 Flange Type 1 – Front view.

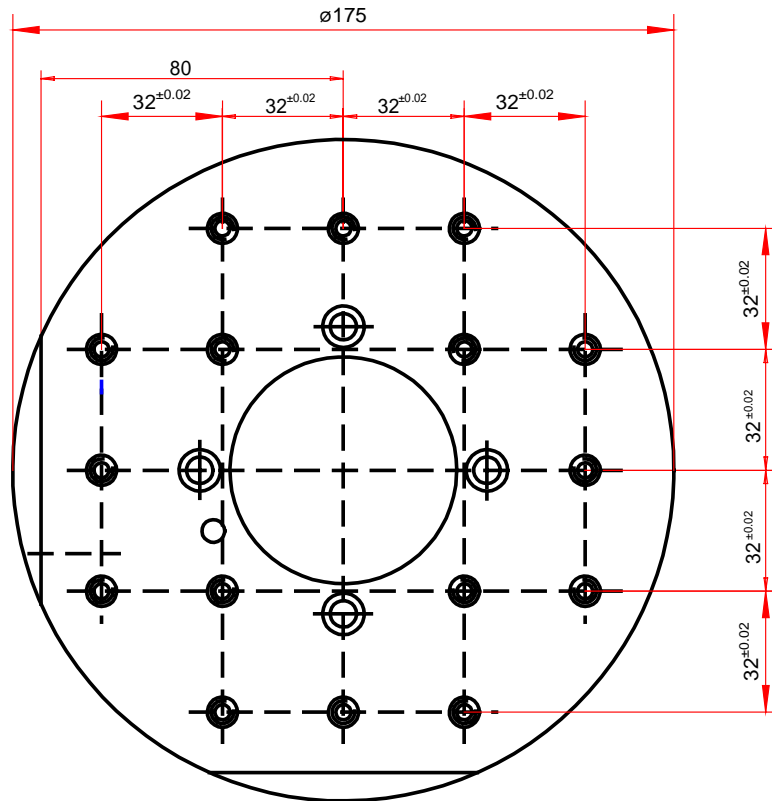

Fig. 2 Detail of one of the 32 x 32 grid of threaded holes. Thin-walled \varnothing_a 8mm tubes, protruding a few mm into the flange may be used to accurately position instrument interfaces on the flange.

